

- LEGEND**
- Life Camp fencing (5.000 s.m.)
 - 01 Accomodations
 - +
 - 02 Infirmary
 - 03 T.V.- bar recreation room
 - 04 Kitchen/pantry dining room
 - 05 Guard house
 - E. C. Life Camp electrical cabinet
 - 06 Tennis court/sooccer field
 - Pedestrian walkway area
 - Meeting - Safety point for emergency (25 s.m.)
 - ||| Crosswalk
 - Driveway
 - P Car parking
 - External Lighting luminaire
 - E. G. Emergency generator
 - T Emergency generator fuel tank
 - W Water cistern

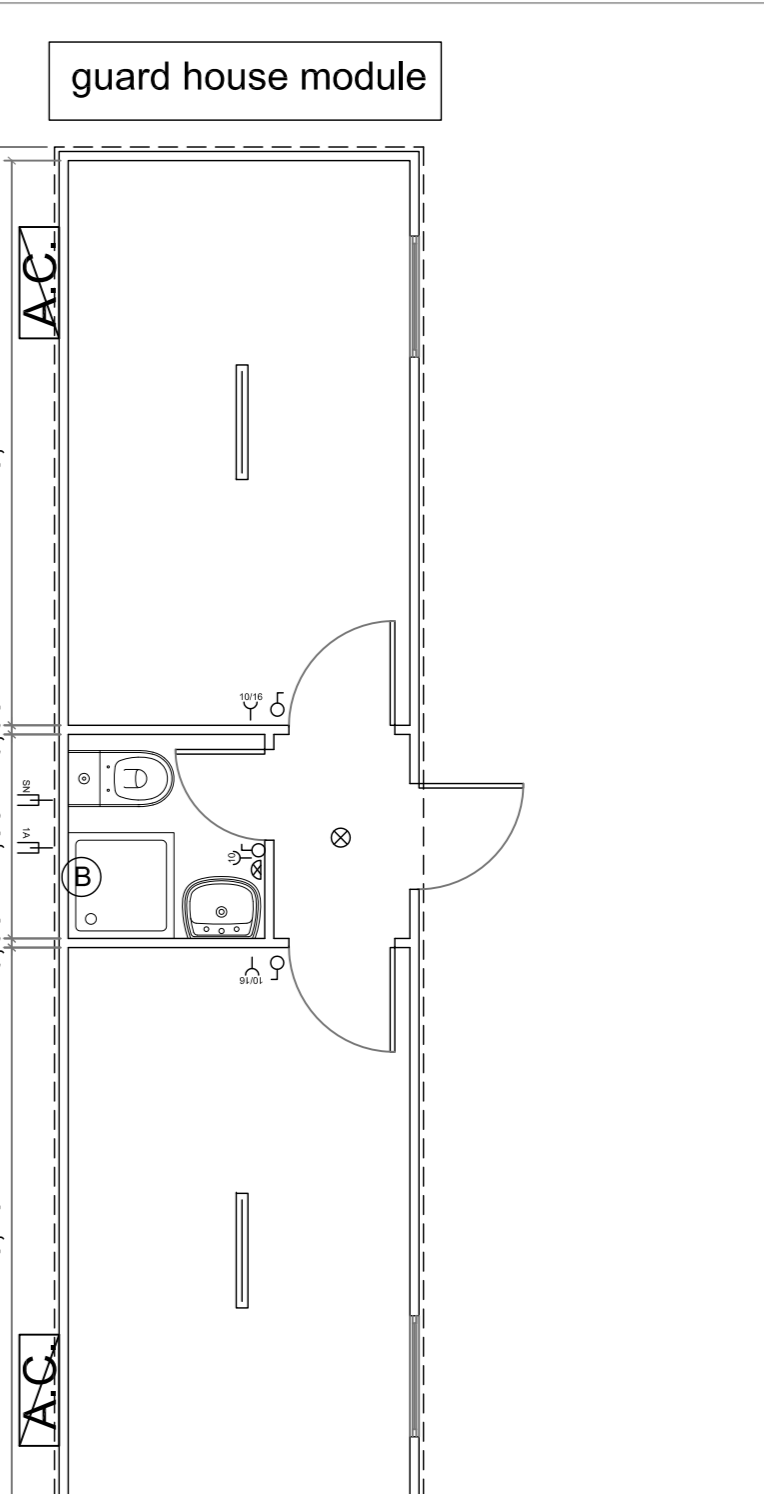
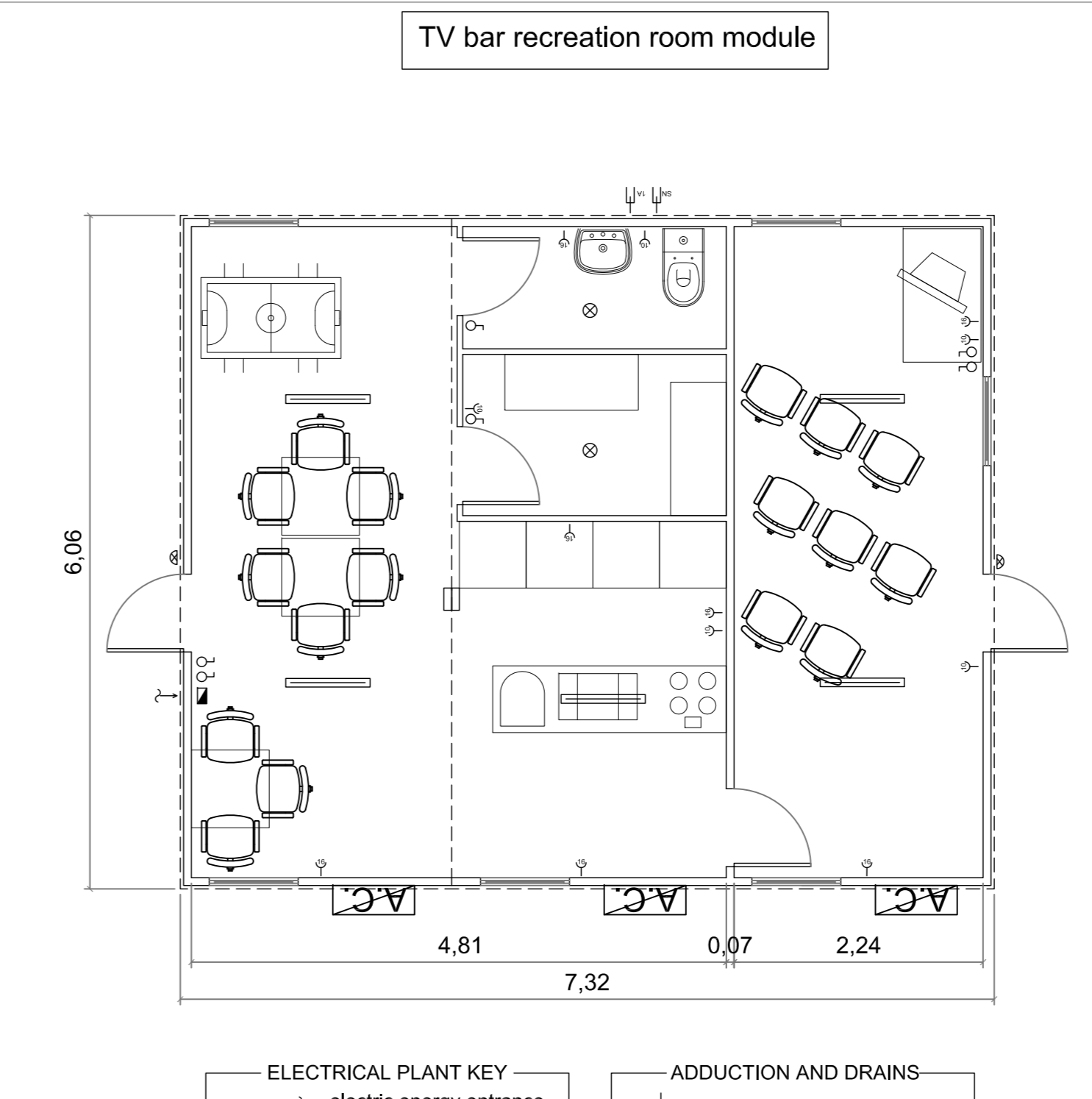
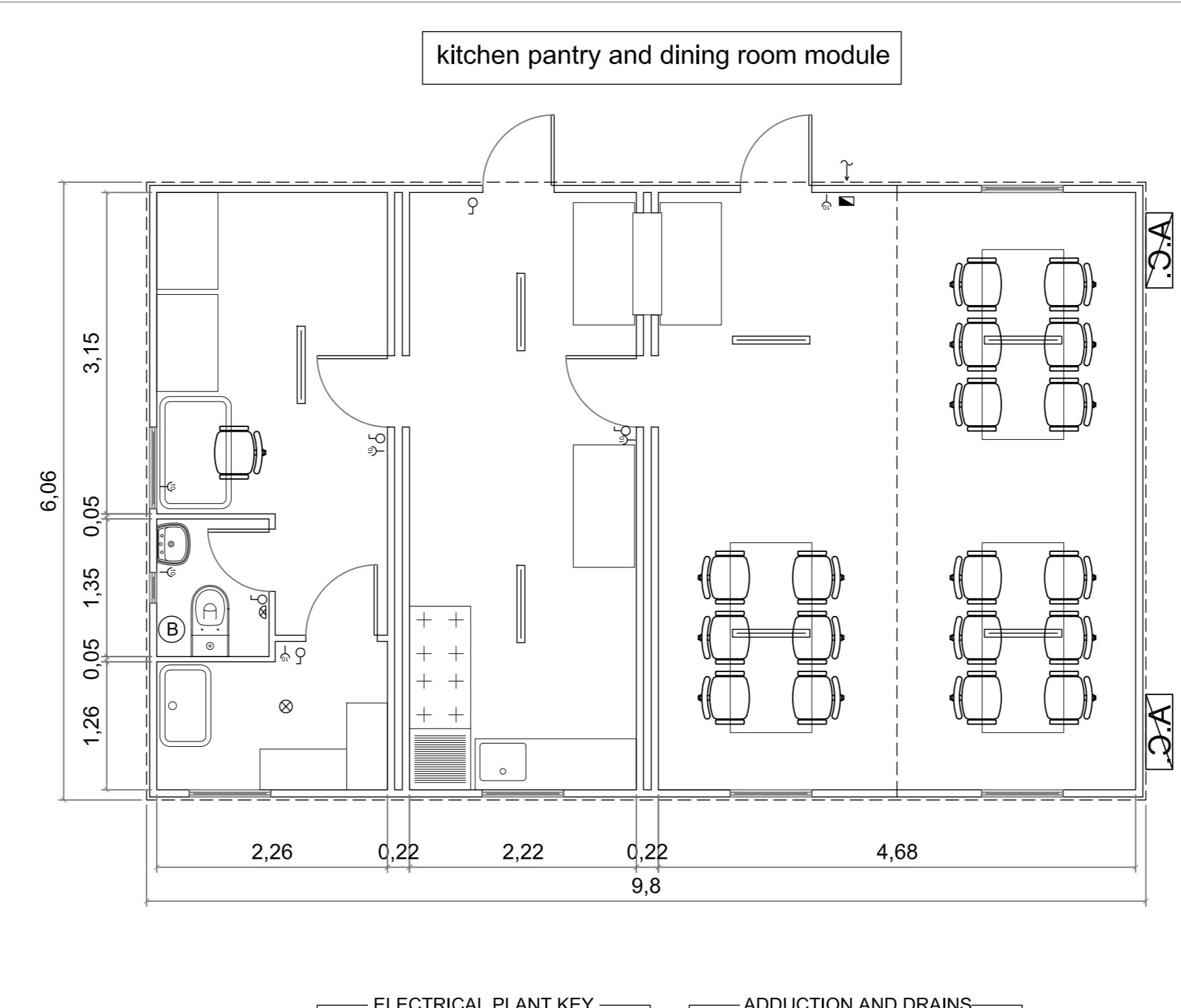
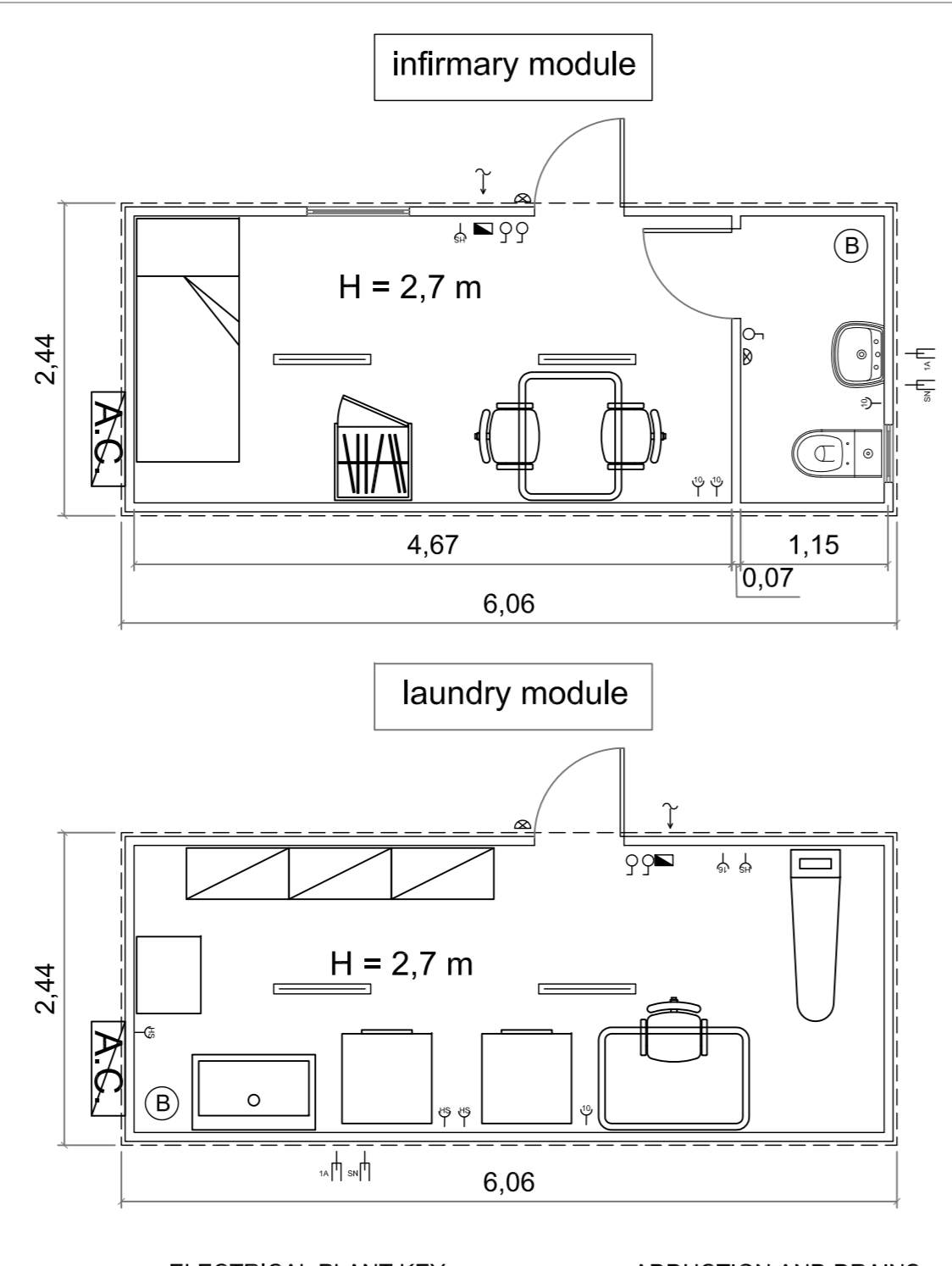
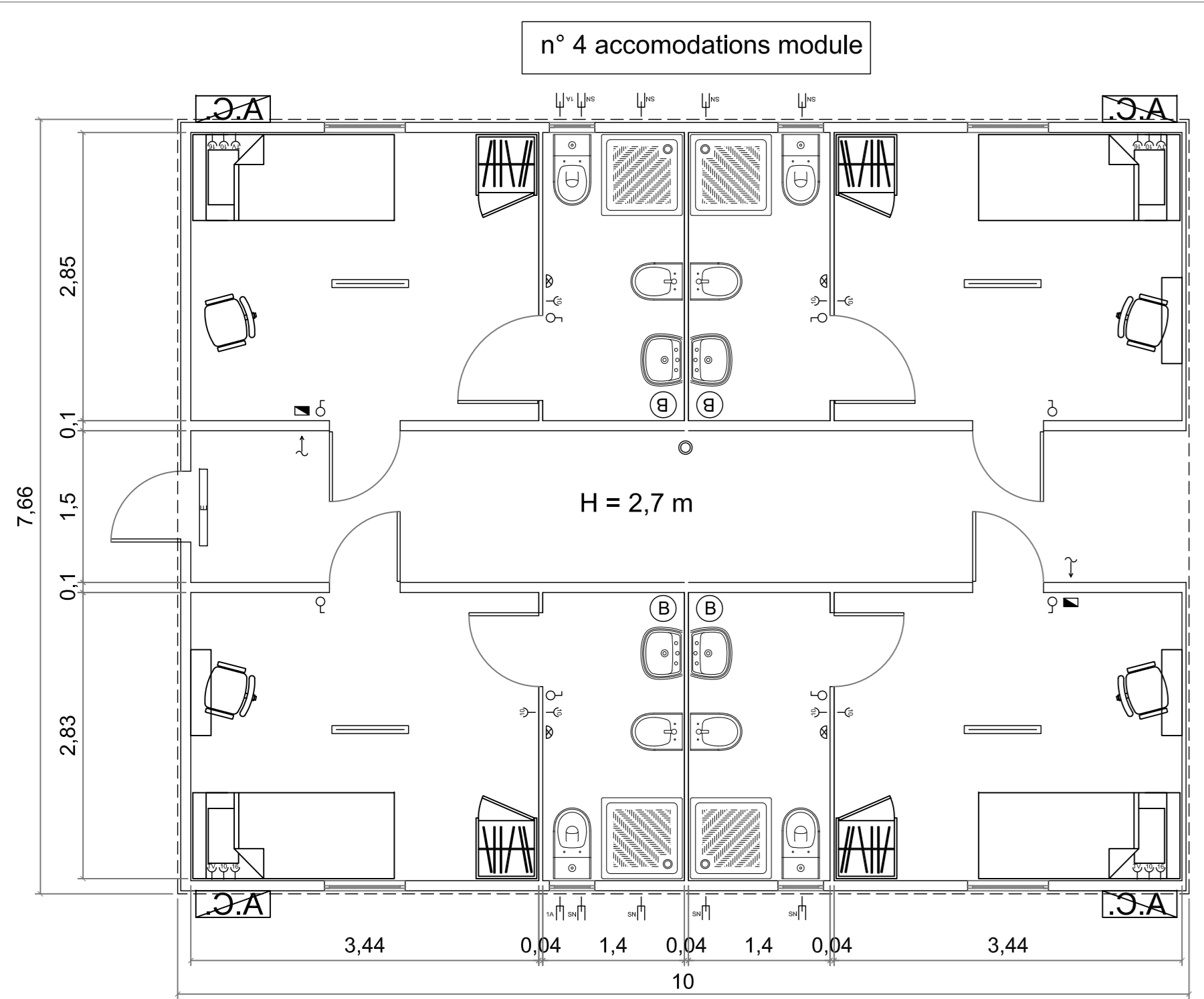

- ELECTRICAL PLANT KEY**
- ↔ electric energy entrance with junction box
 - ⊙ single switch
 - ⊙ T.V. outlet
 - ⊙ 10 Ampere outlet
 - ⊙ 16 Ampere outlet
 - ⊙ push button
 - ⊙ wall light
 - ⊙ neon light
 - ⊙ emergency light
 - ⊙ electrical boiler
 - ⊙ main electrical panel with circuit breaker
- ADDITION AND DRAINS**
- ↔ water adduction diam 1/2" max inlet pressure 3,5 atm
 - ↔ black water drain diam 110 mm

- ELECTRICAL PLANT KEY**
- ↔ electric energy entrance with junction box
 - ⊙ single switch
 - ⊙ T.V. outlet
 - ⊙ 10 Ampere outlet
 - ⊙ 16 Ampere outlet
 - ⊙ Schuco outlet
 - ⊙ push button
 - ⊙ wall light
 - ⊙ ceiling light
 - ⊙ neon light
 - ⊙ emergency light
 - ⊙ electrical boiler
 - ⊙ main electrical panel with circuit breaker
- ADDITION AND DRAINS**
- ↔ water adduction diam 1/2" max inlet pressure 3,5 atm
 - ↔ black water drain diam 110 mm

- ELECTRICAL PLANT KEY**
- ↔ electric energy entrance with junction box
 - ⊙ single switch
 - ⊙ 10 Ampere outlet
 - ⊙ 6 Ampere outlet
 - ⊙ push button
 - ⊙ wall light
 - ⊙ ceiling light
 - ⊙ neon light
 - ⊙ emergency light
 - ⊙ electrical boiler
 - ⊙ main electrical panel with circuit breaker
- ADDITION AND DRAINS**
- ↔ water adduction diam 1/2" max inlet pressure 3,5 atm
 - ↔ black water drain diam 110 mm

- ELECTRICAL PLANT KEY**
- ↔ electric energy entrance with junction box
 - ⊙ single switch
 - ⊙ T.V. outlet
 - ⊙ 10 Ampere outlet
 - ⊙ 6 Ampere outlet
 - ⊙ push button
 - ⊙ wall light
 - ⊙ ceiling light
 - ⊙ neon light
 - ⊙ emergency light
 - ⊙ electrical boiler
 - ⊙ main electrical panel with circuit breaker
- ADDITION AND DRAINS**
- ↔ water adduction diam 1/2" max inlet pressure 3,5 atm
 - ↔ black water drain diam 110 mm

- ELECTRICAL PLANT KEY**
- ↔ electric energy entrance with junction box
 - ⊙ single switch
 - ⊙ 10 Ampere outlet
 - ⊙ 6 Ampere outlet
 - ⊙ push button
 - ⊙ wall light
 - ⊙ ceiling light
 - ⊙ neon light
 - ⊙ electrical boiler
 - ⊙ main electrical panel with circuit breaker
- ADDITION AND DRAINS**
- ↔ water adduction diam 1/2" max inlet pressure 3,5 atm
 - ↔ black water drain diam 110 mm

Client: **Ras Lanuf oil & Gas Processing Co. National Oil Corporation**

Project: **RASCO DESALINATION PLANT RAS LANUF - LIBYA**

Ras Lanuf Oil and Gas Processing Co., National Oil Corporation (RASCO) - Libya

PROGETTO ESECUTIVO

General Contractor / Consortium / Designing Company / Construction Company

Infrastrutture e Gestioni S.p.A.

Drawing Title: **LIFE CAMP ORGANIZATION LAYOUT**

Drawing Code: **8735 00 DW 00 70 01** 1 Sh. 1 of 1

Projection: **AO** Formal: **1/50** Scale: **1/100**

REV.	DATE	DESCRIPTION OF REVISION	ISSUED FOR	PREPARED	CONTROLLED	APPROVED / AUTHORIZED
0	10/06/2013	Final Issue	Construction	C. Binaghi	D. Caridi	D. Caridi

The present document or any part of it is property of INFRASTRUTTURE E GESTIONI S.p.A. and shall not, under any circumstances, be traded or published, transferred, reproduced or copied, distributed or used without the prior written consent of the project owner and any other third party which is involved or shall be liable for the consequences thereof.